

# RC BOATS ARE FUN!

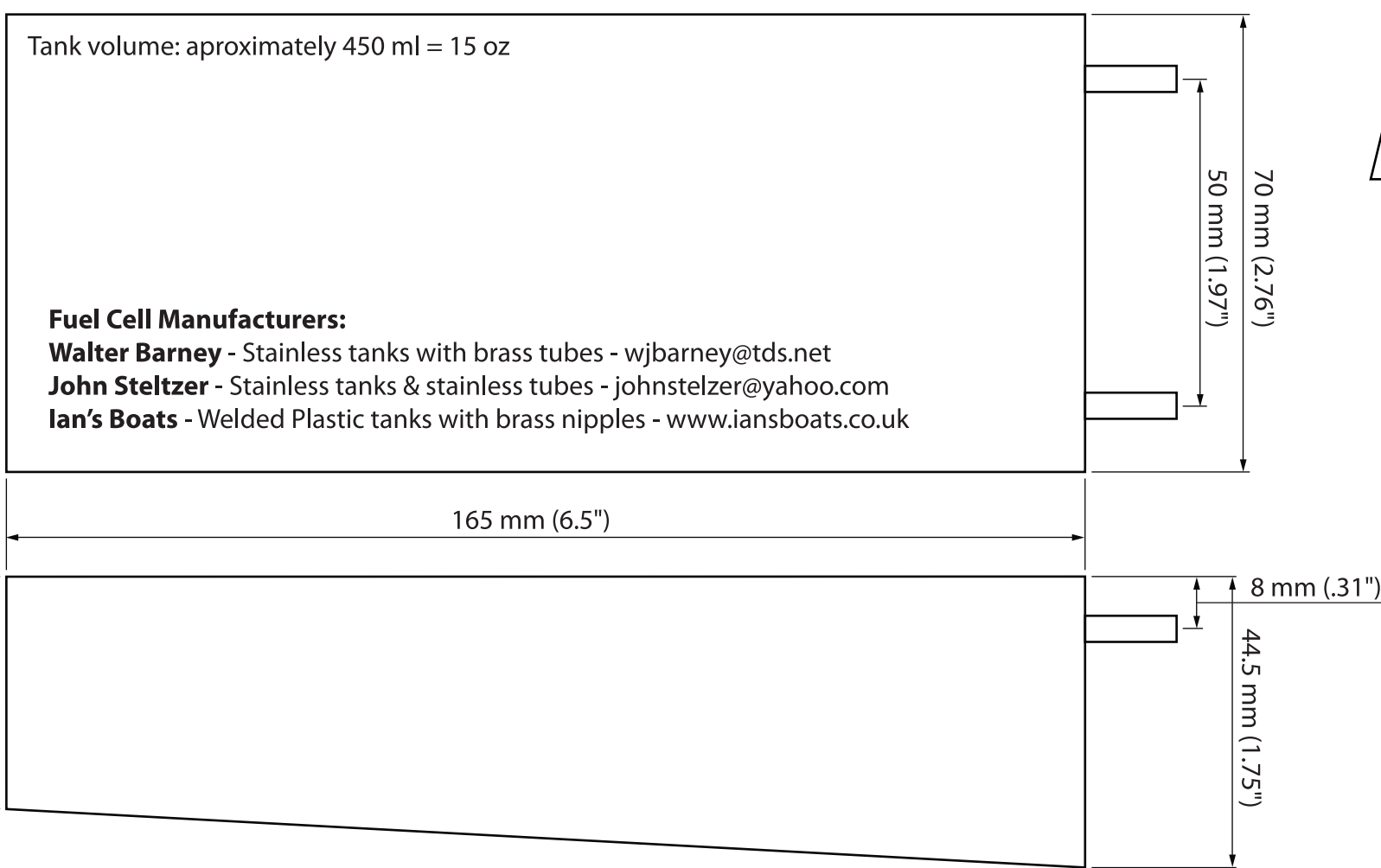

KEP's T3-45 V2 Outrigger Racing Hydro - Freebie PDF 2of2 Templates Version 2.0 / 2018-03-16 Scale: 1:1 / Paper size: A1 = 841 x 594 mm © Design by Niklas Edlund / 2012-2018



**Fuel Cell Manufacturers:**  
**Walter Barney** - Stainless tanks with brass tubes - wjbarney@tds.net  
**John Steltzer** - Stainless tanks & stainless tubes - johnsteltzer@yahoo.com  
**Ian's Boats** - Welded Plastic tanks with brass nipples - www.iansboats.co.uk

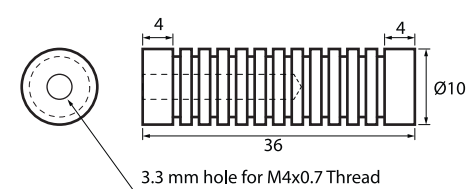

#### Turn-Fin Mount Inserts

- 3 pcs are needed
- Aluminium Bar Stock
- Diameter: 10 mm or (3/8")
- Length: 36 mm (1.42") - it should be slightly longer than the width of the sponson (wich should be around 34 mm)
- Thread: M4 x 0.7 or 6-32
- Glue them with slow epoxy

If 6-32 screws -> drill the (3) holes with 3.7 mm (.145") drill bit  
If M4 screws -> drill the (3) holes with 4.2 mm (.165") drill bit

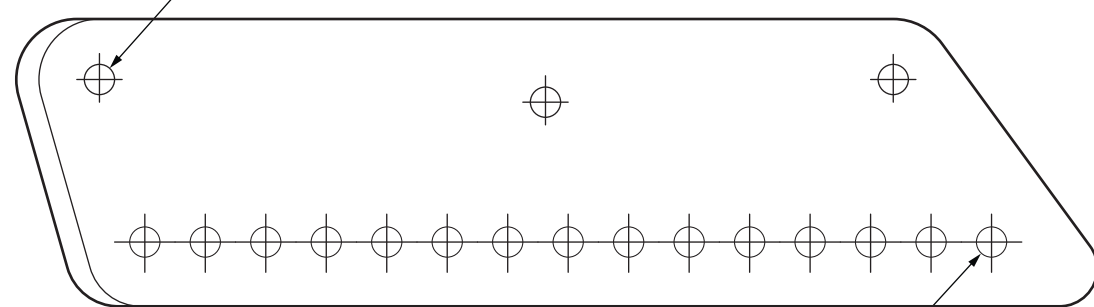

If 6-32 screws -> drill the (15) holes with 4.2 mm (.165") drill bit  
If M4 screws -> drill the (15) holes with 4.5 mm (.177") drill bit

#### Turn-Fin Mount Plate

- Aluminium Plate Stock (like 7075-T6) or 3 mm (1/8") Carbon High Strength
- Material thickness: 3-4 mm (1/8" to 5/32")
- Use either M4 or 6-32 screws
- Cut out the printed drawing and use removeable spray glue to attach it to the prefered plate material and use that as a template for drilling and cutting it out.

#### Removeable Ridepads

- Note that the ridepads are designed to be mounted to the tub with 0.7-1 mm (.03"-.04") thick double sided tape (removeable!).
- Keep edges flat and square and don't put too much radius on the corners.
- Normally you don't need to paint the ridepads (or ski). Personally I just use laminating epoxy because then it's easier to keep the edges "sharp".
- Remember: *REMOVEABLE!*

**Removeable Ridepads - Aircraft Birch Plywood**  
200 x 40 mm (7.87" x 1.65") - 2/2.5/3 mm thick (.078"/.098"/.012")

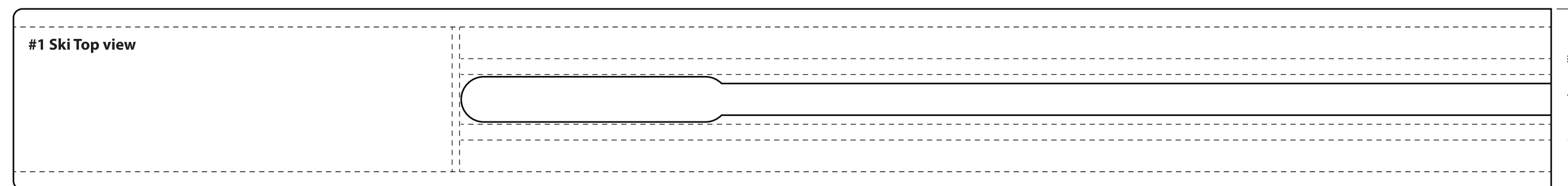

#### #1 Removeable rear ski with strakes

- This is a bit more complex to do but it's well worth the extra work
- The boat tracks better and handles better in the corners
- Note that the ski is designed to be mounted to the tub with 0.7-1 mm (.03"-.04") thick double sided tape (removeable!)
- Keep edges flat and square and don't put too much radius on the corners.
- Normally you don't need to paint the ski (or ridepads). Personally I just use laminating epoxy because then it's easier to keep the edges "sharp".
- Remember: *REMOVEABLE!*

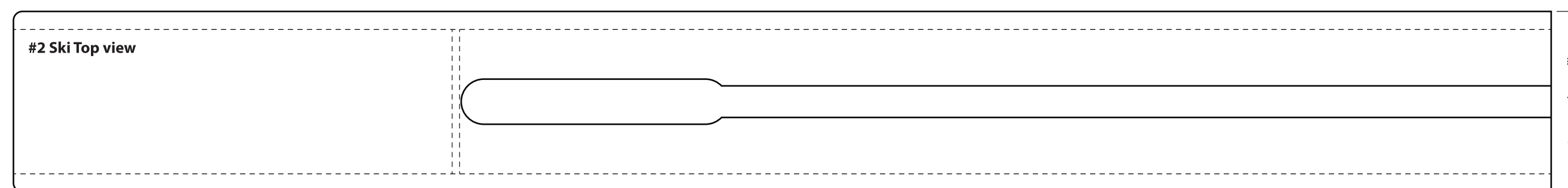
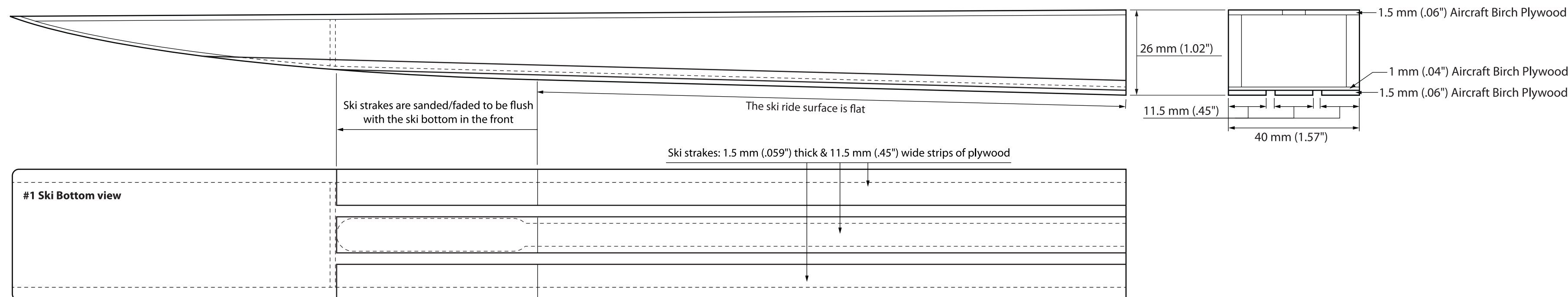

#### #2 Removeable standard rear ski

- Note that the ski is designed to be mounted to the tub with 0.7-1 mm (.03"-.04") thick double sided tape (removeable!)
- Keep edges flat and square and don't put too much radius on the corners.
- Normally you don't need to paint the ski (or ridepads). Personally I just use laminating epoxy because then it's easier to keep the edges "sharp".
- Remember: *REMOVEABLE!*

